

## MBSS 2a

### DIAGNOSTIC FACILITY INTERROGATION

The system is able to inform the user of the failure of certain critical security functions. During the first 4 minutes the vehicle is being driven, if a fault is detected, the red LED located in the interior rear view mirror (or in the glove box recess on model 170) will flash once every 10 seconds.

After 10 engine starts, the red LED will no longer signal the condition during driving but the specific failure mode detected may be identified by the installer running the System Interrogation procedure below.

To check at any time the number of keys programmed to operate the system or to check if the system is operating correctly. With the system in the unset condition open and leave opened the driver's or passenger's door, turn the ignition ON and press the touch key against the receptacle until the red LED in the interior rear view mirror (or in the glove box recess on model 170) will signal the number of keys programmed for the system displaying one flash for each key. As soon as the ignition is switched off, the system identifies a specific security failure mode if applicable:

No. of flashes (every 3 seconds)	Failure mode
2	Ultrasonic sensors
3	Driver's door contact
4	Boot input, bonnet input, other doors contacts
8	Siren battery low

To exit this procedure simply close the driver's door.

## Please note

The LED on the 'A' Class is located on the Right hand side of the dash by the lighting switch. The touch key(Alarm Key)socket is located inside the glove box left hand side.



### PROGRAMMING REPLACEMENT OR ADDITIONAL KEYS

If a black key is lost, it is possible to supply a new key and to programme it by following the procedure below:

**N.B.** Without the RED MASTER KEY, it is impossible to programme new keys.

It is possible to programme additional keys up to a maximum of four keys (including the master) per system at any one time. With the ignition turned OFF and the system in the unset condition, open the boot and the driver's door. Turn the ignition ON then, within 10 seconds, press the RED MASTER KEY against the receptacle until the red LED flashes for 1 second then displays a constant red. Press the RED MASTER KEY against the receptacle a second time until the red LED switches off. Turn the ignition off, the red LED will become constant once more, and the programming procedure is now available to use.

#### Programming keys:

To re-programme the existing touch key(s) and any additional ones purchased simply press each key against the receptacle. The red LED confirms acceptance by switching off for half a second.

Having completed the above procedure for each key exit the procedure by pressing the RED MASTER KEY against the receptacle until the red LED extinguishes itself. The red LED will remain extinguished for 1 second. One long flash every second signals the number of touch keys programmed. This will continue until the driver's door and boot are closed.

**N.B.** For security reasons there is NO way to exit the programming procedure other than by using the RED MASTER KEY.

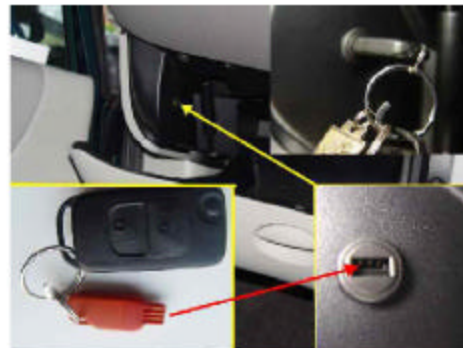

Please use the back button to return to the previous page